

Noble BE33

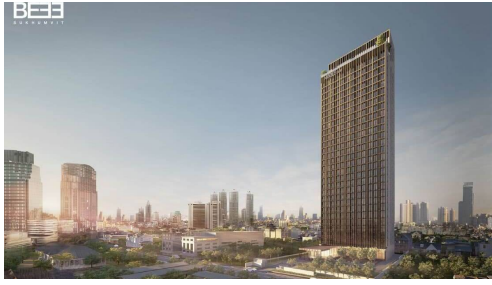

Seller Info

Name: MyThai Agent
 First Name: MyThai
 Last Name: Agent
 Company Name: MyThai Property
 Service Type: Buying or Selling
 Mobile:
 Phone: +1 (415) 800-2828
 Website: <http://mythai.property>
 Country: Thailand
 ZIP code: 55444
 Address: Landao
 About me: I am the official MyThai Property website agent, feel free to contact me at any time!

Listing details

Common

Title: Noble BE33
 Property for: Sale
 Price: ฿ 6,262,000.00
 Bedrooms: 1
 Bathrooms: 1
 Square Feet: 34 m2 ft
 Posted: Dec 12, 2020

Price Range

Price Range: eyIxIjp7InR5cGUiOiIxIEJlZCBNYXg6Iiwic2l6ZSI6IjQzbTIiLCJwcmVlcmljZSI6IjE1NDYwMDB8Y3VycmVuY3lfdGhiIn0sIjMiOmsidHlwZSI6IjI1bjoIiLCJzaXplIjoiNTFtMiIsInByaWNlIjoiMTAxMTUwMDB8Y3VycmVuY3lfdGhiIn0sIjQiOmsidHlwZSI6IjI1bjoIiLCJzaXplIjoiNTFtMiIsInByaWNlIjoiMTUwMDB8Y3VycmVuY3lfdGhiIn0sIjYiOmsidHlwZSI6IjI1bjoIiLCJzaXplIjoiNTFtMiIsInByaWNlIjoiMTUwMDB8Y3VycmVuY3lfdGhiIn0sIjciOmsidHlwZSI6IjI1bjoIiLCJzaXplIjoiNTFtMiIsInByaWNlIjoiMTUwMDB8Y3VycmVuY3lfdGhiIn19

Payment Plan

Reservation Fee: ฿ 100,000.00
Contract Deposit: 30% (within 30 days)
Instalments: N/A
Handover: 70%

Location

City: Bangkok
District: Sukhumvit (Central)

Additional information

E-mail (import): info@findthaiproperty.com
Mobile (import): +66 (0) 800 844 727

Description: Reduced Prices for a limited time! Competitive price per m2 in the heart of Asoke / Phrom Phong, Sukhumvit Road....
Noble BE33 is a brilliantly located condominium in the heart of Sukhumvit Road, between Asoke BTS and Phrom Phong BTS, nestled in the quiet and secluded Sukhumvit Soi 33. Asoke is one of Bangkok's major CBD's due to the intersection between Sukhumvit...View more
Reduced Prices for a limited time! Competitive price per m2 in the heart of Asoke / Phrom Phong, Sukhumvit Road....
Noble BE33 is a brilliantly located condominium in the heart of Sukhumvit Road, between Asoke BTS and Phrom Phong BTS, nestled in the quiet and secluded Sukhumvit Soi 33. Asoke is one of Bangkok's major CBD's due to the intersection between Sukhumvit Rd. and Ratchadapisek Rd., while Phrom Phong offers the finest in Bangkok shopping with the stunning EM District, Emporium Mall, Emquartier Mall connected by skywalk....all on your doorstep. Noble BE33 is surrounded by attractions and amenities that are endless. BTS Phrom Phong is 700m from the residence and accessible by walking (8 min) or by the private residential BTS shuttle service.
Noble BE33 is a high-rise condominium built by one of Bangkok's leading development companies. There are 31 floors with a total of 277 units ranging in the following sizes: 1 Bedroom (34m2 – 43m2), 2 Bedroom (51m2 – 69m2), 3 Bedroom (76m2). With

over 1,000m2 of garden and courtyard areas, this residence is an oasis in the heart of the bustling city. The facilities at Noble BE33 reflect the needs of the modern BKK resident, featuring: Infinity Edge Swimming Pool, Kids Pool, Sky Fitness Centre, Sky Multipurpose Room, Steam Room, Reflective Lobby, Mailroom, Semi-Outdoor Lounge, 1000+m2 of Garden & Courtyard, 24-Hour Security & CCTV, Keycard Access, Private BTS Shuttle Service. This is fantastic value for money for a brand new launch in the highly developed market of Asoke, Sukhumvit Road. Be sure to enquire while this offer lasts!View less