

The Base Saphanmai

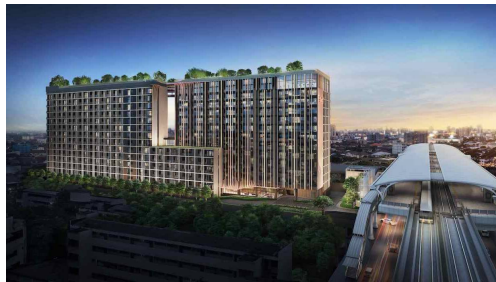

Seller Info

Имя:	MyThai Agent
Имя:	MyThai
Фамилия:	Agent
Название компании:	MyThai Property
Тип объявления:	Покупка или продажа
Мобильный:	
Телефон:	+1 (415) 800-2828
Веб-сайт:	http://mythai.property
Страна:	Thailand
Почтовый индекс:	55444
Адрес:	Landao
Обо мне:	I am the official MyThai Property website agent, feel free to contact me at any time!

Listing details

Общее

Название:	The Base Saphanmai
Недвижимость для:	Продажи
Цена:	฿ 2,152,000.00
Спальни:	1
Ванные комнаты:	1
Площадь:	24 m2 ft
Опубликовано :	18.11.2020

Цены

Ценовая категория:	eyJxIjpw7InR5cGUiOiIxIEJlZCBNYXg6Iiwic2l6ZSI6IjM0bTIiLCJwcmVudCJyZW5jeV90aGlifSwiNCI6eyJ0eXBIIjoiMiBCZWQgTWF4OiIsInNpemUiOiI1NW0yIiwicHJpY2UiOiI1NzMDAwfGN1cnJlbnN5X3RoYiJ9fQ==
--------------------	---

План оплаты

Сумма залога:	฿ 100,000.00
Contract Deposit:	25% (within 14 days)

Взносы: Недоступно
Передача в 75%
собственность:

Место нахождения

Город: Бангкок
Район: Phaya Thai / Chatuchak

ДОПОЛНИТЕЛЬНАЯ ИНФОРМАЦИЯ

E-mail : info@findthaiproperty.com
Mobile (import): +66 (0) 800 844 727

Описание: Only 30m to BTS Sai Yud Station! The Base Saphanmai is the latest in a legacy of popular Base series of projects by Thailand’s most popular public listed developer – Sansiri. We have access to a superb portfolio of units here. This is your chance to be a part of the Bangkok metro expansion and buy at incredible value directly on a new station.

The Base Saphanmai is located in...View moreOnly 30m to BTS Sai Yud Station! The Base Saphanmai is the latest in a legacy of popular Base series of projects by Thailand’s most popular public listed developer – Sansiri. We have access to a superb portfolio of units here. This is your chance to be a part of the Bangkok metro expansion and buy at incredible value directly on a new station.

The Base Saphanmai is located in “Saphanmai”, the residential location filled with a multitude of transportation possibilities. A mere stop away from the heart of the city from its setting directly next to Sai Yud BTS Station. Connecting you to the MRTA Pink Line and the MRT Chaloem Ratchamongkhon. Close to the Ramindra - Artnarong expressway and Don Mueang Tollway. Surrounded by lifestyle destinations for shopping and dining that will conveniently place you in the best position to enjoy a great perspective of Bangkok for years to come.

The Base Saphanmai is a medium-rise residential tower with 14 floors, 1 Clubhouse (2 floors) and a total number of 820 residential units. Facilities include the following and are planned to be open 24-hours: Botanical Lobby, Clubhouse & Recreation

on 1st Floor, 2nd Floor Atrium, Theatre Pavilion,
Rooftop Spiral Bridge, Relax Bar, Cinema,
Co-Working Space, 1st Floor Outdoor Garden, 6th
Floor Outdoor Garden, Panoramic Rooftop Gym,
His / Hers Steam Rooms, Rooftop Swimming Pool,
Kids Pool, Playground & Sky Garden,
Multi-Purpose Room, Self-Laundry, WIFI, EV
Charging Station, 24 Hour Security, 24 Hour CCTV,
Key-Card Access.

Unit sizes on offer at The Base Saphanmai include:
1 Bedroom (24m² – 34m²) and 2 Bedroom (55 m²).
All units come Fully Furnished for a limited period –
enquire now. View less