

Noble BE33

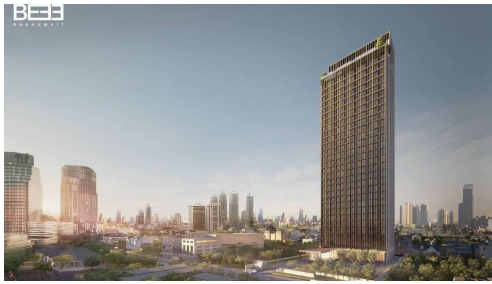

Seller Info

Имя: MyThai Agent
 Имя: MyThai
 Фамилия: Agent
 Название компании: MyThai Property
 Тип объявления: Покупка или продажа
 Мобильный: +1 (415) 800-2828
 Телефон: +1 (415) 800-2828
 Веб-сайт: <http://mythai.property>
 Страна: Thailand
 Почтовый индекс: 55444
 Адрес: Landao
 Обо мне: I am the official MyThai Property website agent, feel free to contact me at any time!

Listing details

Общее

Название: Noble BE33
 Недвижимость для: Продажи
 Цена: \$ 6,262,000.00
 Спальни: 1
 Ванные комнаты: 1
 Площадь: 34 m2 ft
 Опубликовано : 12.12.2020

Цены

Ценовая категория: eyIxIjp7InR5cGUiOiIxIEJIZCERNYXg6Iiwic2l6ZSI6IjQzbTIiLCJwcmlljZSI6IjklNDYwMDB8Y3VycmVuY3lfdGhiIn0sIjMiOjnsidHlwZSI6IjIgQmVkie1pbjoiLCJzaXplIjoiNTFtMiIsInByaWNlIjoimTAxMT EwMDB8Y3VycmVuY3lfdGhiIn0sIjQiOjnsidHlwZSI6IjIgQmVkie1heDoiLCJzaXplIjoiNjltMiIsInByaWNlIjoimTUyNjgwMDB8Y3VycmVuY3lfdGhiIn0sIjYiOjnsidHlwZSI6IjIgMgQmVkie1pbjoiLCJzaXplIjoimNzZtMiIsInByaWNlIjoimTU0MT EwMDB8Y3VycmVuY3lfdGhiIn0sIjciOjnsidHlwZSI6IjIgMgQmVkie1heDoiLCJzaXplIjoiNzZtMiIsInByaWNlIjoimTYyNTcwMDB8Y3VycmVuY3lfdGhiIn19

План оплаты

Сумма залога:	฿ 100,000.00
Contract Deposit:	30% (within 30 days)
Взносы:	Недоступно
Передача в собственность:	70%

Место нахождения

Город:	Бангкок
Район:	Sukhumvit (Central)

ДОПОЛНИТЕЛЬНАЯ ИНФОРМАЦИЯ

E-mail :	info@findthaiproperty.com
Mobile (import):	+66 (0) 800 844 727

Описание:	<p>Reduced Prices for a limited time! Competitive price per m2 in the heart of Asoke / Phrom Phong, Sukhumvit Road....</p> <p>Noble BE33 is a brilliantly located condominium in the heart of Sukhumvit Road, between Asoke BTS and Phrom Phong BTS, nestled in the quiet and secluded Sukhumvit Soi 33. Asoke is one of Bangkok's major CBD's due to the intersection between Sukhumvit... View more</p> <p>Reduced Prices for a limited time! Competitive price per m2 in the heart of Asoke / Phrom Phong, Sukhumvit Road....</p> <p>Noble BE33 is a brilliantly located condominium in the heart of Sukhumvit Road, between Asoke BTS and Phrom Phong BTS, nestled in the quiet and secluded Sukhumvit Soi 33. Asoke is one of Bangkok's major CBD's due to the intersection between Sukhumvit Rd. and Ratchadapisek Rd., while Phrom Phong offers the finest in Bangkok shopping with the stunning EM District, Emporium Mall, Emquartier Mall connected by skywalk....all on your doorstep. Noble BE33 is surrounded by attractions and amenities that are endless. BTS Phrom Phong is 700m from the residence and accessible by walking (8 min) or by the private residential BTS shuttle service.</p> <p>Noble BE33 is a high-rise condominium built by one of Bangkok's leading development companies. There are 31 floors with a total of 277 units ranging</p>
-----------	---

in the following sizes: 1 Bedroom (34m² – 43m²), 2 Bedroom (51m² – 69m²), 3 Bedroom (76m²). With over 1,000m² of garden and courtyard areas, this residence is an oasis in the heart of the bustling city. The facilities at Noble BE33 reflect the needs of the modern BKK resident, featuring: Infinity Edge Swimming Pool, Kids Pool, Sky Fitness Centre, Sky Multipurpose Room, Steam Room, Reflective Lobby, Mailroom, Semi-Outdoor Lounge, 1000+m² of Garden & Courtyard, 24-Hour Security & CCTV, Keycard Access, Private BTS Shuttle Service. This is fantastic value for money for a brand new launch in the highly developed market of Asoke, Sukhumvit Road. Be sure to enquire while this offer lasts!View less